

# H57

## Low Cost Hour Meter

### Features

- UL Listed, CE Certified
- Low Cost
- 7 Digit Display (99999.99 Hours)
- AC or DC Voltages
- Small Case

### Description:

These meters are mainly used for monitoring the running time of machines, apparatus and instruments as well as for recording maintenance time, warranty time or rental use time. A synchronous motor operating through a gear train drives the number wheels for the display of full hours 1/10 h and 1/100 h. On AC-versions, the main supply (50 or 60 Hz) is used as frequency standard. On DC-versions the exact frequency generated by means of a quartz crystal. A rugged and completely insulated plastic housing provides substantial protection against environmental influences.

### Specifications:

**Termination:** Flat tabs .031 x .250" with screw terminal

**Voltages:** 24, 110, 220 VAC +15%, 50 Hz or 60Hz  
12 to 24, 36 to 80, 110 VDC ± 10 %

**Test Voltage:** 2000V, 50 Hz

**Ambient temperature:**

-15° to +50°C on AC; -20° to +60°C on DC

**Power Consumption:**

Appr. 2 VA at 220 VAC; Appr. 180 mW at 12 VDC

**Hour range:** AC Units: 99999.99 hours  
DC Units: 999999.99 hours

**Height of Figures:** 4 mm

**Color of Figures:**

Hours: white on black, Decimals: red on black

**Color of Housing:** Black

**Operation indicator:** Fast rotating, white

**Approvals:** UL Listed: File # E128604X, CE Approved

**Weight:** AH57: 84g; H57 48g

### How To Order:

**EXAMPLE:** H57 24VAC 60Hz

#### Series

- H57 = Panel Mount
- AH57 = Base Mount
- H57.55 = Extended 2.16" x 2.16"  
Bezel for 2" diameter cutout
- H57.72 = Extended 2.83" x 2.83"  
Bezel for 2" diameter cutout

#### Voltages

- 12, 24, 36, 80, 110 VDC
- 24, 40, 110, 220 VAC

#### Frequency (AC units only)

- 50 or 60Hz (Specify)

#### Accessories

- DR-4 = 4 DIN Rail (DIN 46277)



### Dimensions:

#### H57 (Panel Mount)

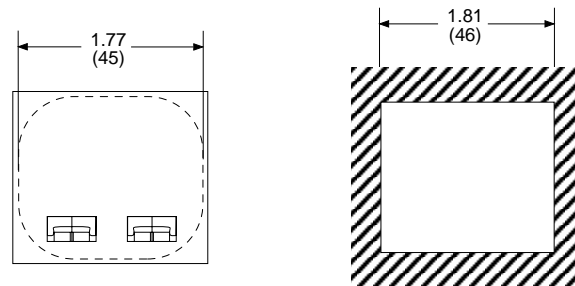
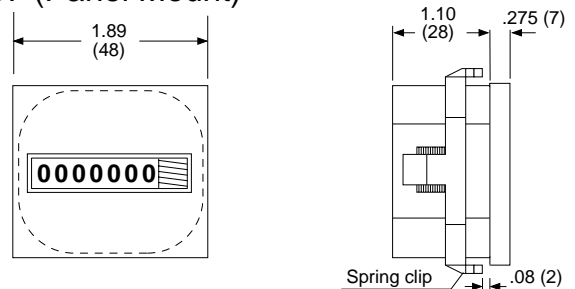

#### AH57 (Base Mount) & DIN Rail Mount

