

REFERENCE: MPCL 98 CAT. P76		REVISION				
GENERAL DESCRIPTION: MODEL LP-xxxFZ IS A SEALED, CONDUCTIVE PLASTIC LINEAR POTENTIOMETER DESIGNED FOR HARSH OUTDOOR APPLICATIONS. ITS SEALED CONSTRUCTION, STURDY ALUMINUM CASE AND ø12mm (0.47"DIA.) SHAFT ALLOW THE POTENTIOMETER TO ENDURE OPERATIONS IN SEVERE OUTDOOR AMBIENT AS WELL AS IN OILY, DUSTY MACHINERY APPLICATIONS.	C.O.N	SYM	DESCRIPTION	DATE	DRAWN	APPR'D
		A	1) RESISTANCE VALUE, 0.5k AND 30k REMOVED AND 20k WAS STD. 2) SEAL COMPLIANCE ADDED.	08/14/03	T.TSUGAWA	

CAUTION:
DO NOT EXPOSE THESE AREAS TO ANY LIQUID TO PREVENT THE LIQUID FROM PENETRATING THROUGH THE WIRES INTO INTERIOR OF THE CASE.

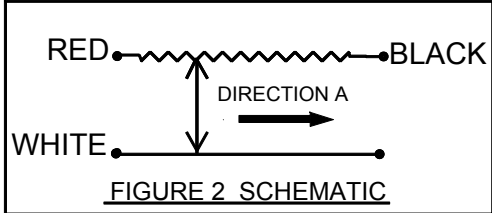
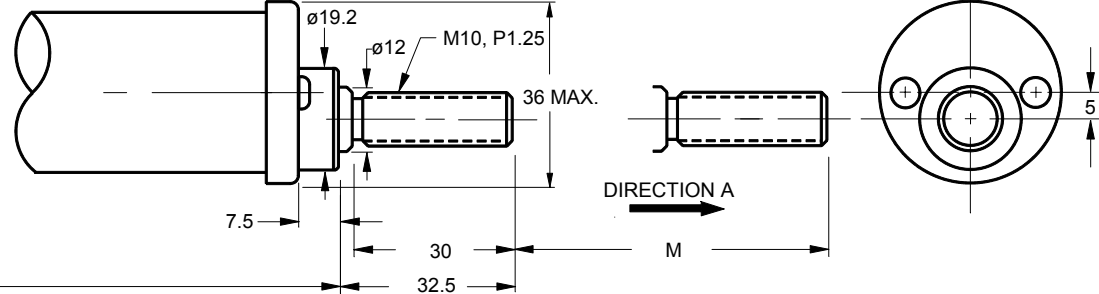
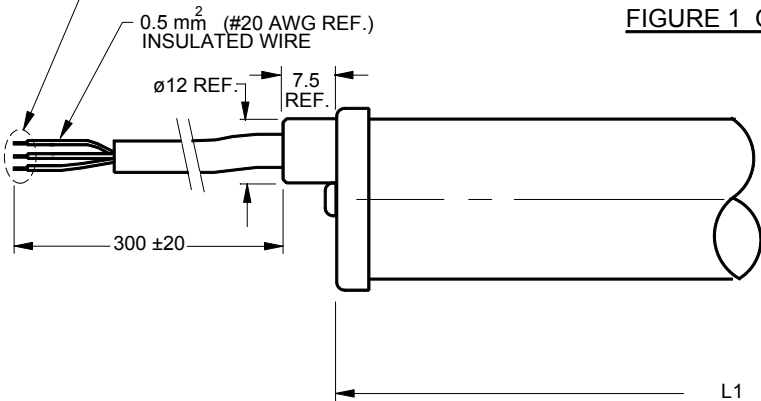

FIGURE 1 OUTLINE DIMENSION



SPECIFICATIONS

MODEL NO.:	LP-50FZ	LP-100FZ	LP-150FZ	LP-200FZ	LP-250FZ	LP-300FZ	LP-400F
ELECTRICAL STROKE:	50 mm	100 mm	150 mm	200 mm	250 mm	300 mm	400 mm
MECH. STROKE (M):	53±1 mm	103±1 mm	153±1 mm	203±1 mm	253±1 mm	303±1 mm	403±1 mm
RESISTANCE in kΩ (±20%):	1, 2, 5	1, 2, 5, 10	1, 2, 5, 10	1, 2, 5, 10 (20 AVAILABLE)	2, 5, 10 (20 AVAILABLE)	2, 5, 10 (20 AVAILABLE)	5, 10
POWER RATING :	1.5 W @ 70°C	2.5 W @ 70°C	3 W @ 70°C	4 W @ 70°C	4 W @ 70°C	4 W @ 70°C	4.5 W @ 70°C
HOUSING LENGTH (L1):	100 ±1 mm	150 ±1 mm	200 ±1 mm	250 ±1 mm	300 ±1 mm	350 ±1 mm	400 ±1 mm
INDEPENDENT LINEARITY:	±0.5% (±0.2% AVAILABLE)	±0.3% (±0.1% AVAILABLE)	±0.3% (±0.1% AVAILABLE)	±0.3% (±0.1% AVAILABLE)	±0.3% (±0.1% AVAILABLE)	±0.3% (±0.1% AVAILABLE)	±0.1%
WEIGHT:	APPROX. 260g	APPROX. 340g	APPROX. 430 g	APPROX. 510g	APPROX. 590g	APPROX. 680g	APPROX. 850g

OUTPUT SMOOTHNESS: 0.1% MAX.
 INSULATION RESISTANCE: 100 meg OHMS MIN. @ 500 Vdc
 DIELECTRIC STRENGTH: 500 Vrms @ 50/60 Hz for 1 MINUTE
 OPERATING TEMPERATURE: -40°C to +125°C
 TEMPERATURE COEFFICIENT: ±400 ppm/°C MAX.
 FRICTION: 2 kgf MAX.
 SEAL COMPLIANCE: IP64

UNLESS OTHERWISE SPECIFIED, DIMENSIONS ARE IN mm(in). TOLERANCES: ANGLES: ±1.5° <10 mm: ±0.25 <100 mm: ±0.5 >100 mm: ±1	DRAWN T. TSUGAWA	DATE 06/16/98	SPECIFICATION DWG FOR MODEL LP-xxxFZ LINEAR POTENTIOMETER WATER-PROOF CONSTRUCTION	PRECISION SALES 610-359-1002 F: 610-353-1674
	CHECKED	DATE		
	APPROVED	DATE		
	APPROVED	DATE		
SCALE:	FILE: LP-xxxFZ		B-MAC-B20 A	
			1 OF 1	